

145.3FC

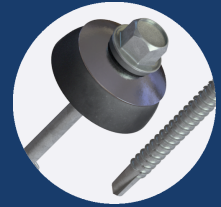

FOR FASTENING FIBRE CEMENT CORRUGATED SHEETS (60MM-105MM THICKNESS) TO PURLINS OF 1.5MM-6MM THICKNESS. SUPPLIED WITH BAZ WASHER.

PROPERTIES



MATERIAL	CARBON STEEL
COATING	500 HRS (SILVER)
HEAD TYPE	HEX
DRILL POINT	3 PT
EFFECTIVE THREAD LENGTH	69.00
RECOMMENDED DRILL BIT/SOCKET	SOCKET-HEX-5/16" MAG
RECOMMENDED DRILL SPEED	1500 - 2500 RPM

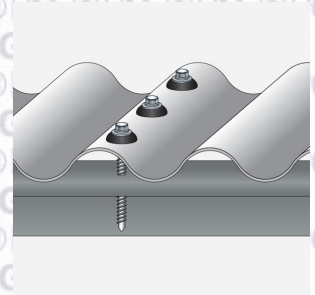

PERFORMANCE

PULL OUT

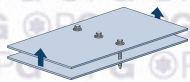

STEEL THICKNESS (MM)	2.00	4.00	6.00	N/A	N/A
VALUE (kN)	5.32	9.42	14.38		

Grade of material: S275 Steel

PULL OVER

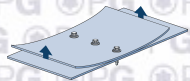

WASHER	16MM x 2MM		19MM x 2MM	
SHEET THICKNESS (MM)	0.50	0.70	0.50	0.70
VALUE (kN)				

SHEAR



VALUE (kN)	9.60
------------	------

TENSILE



VALUE (kN)	16.00
------------	-------

DIMENSIONS

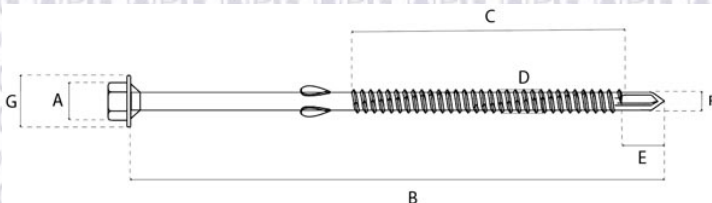

A (MM)	8.64
B (MM)	145.00
C (MM)	74.00
D (MM)	6.35
E (MM)	9.50
F (MM)	5.52
G (MM)	12.70